

TAKE OUT TECH



Roku Express Streaming Player

Borrow for 2 weeks!

Lake Forest residents only
Ages 16 and up

Late fine: \$2/day

**KIT
ROKU
EXPRESS**

3124300 634 6638



Roku Express Streaming Player

How to Use

1. Connect the **Roku Express Player** to your TV using the **HDMI cable**.

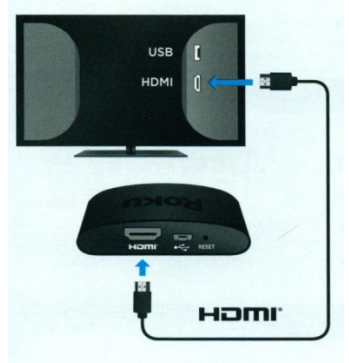

2. Connect the **Roku Express Player** to a power source using the **USB power cable** and **AC power adaptor**.

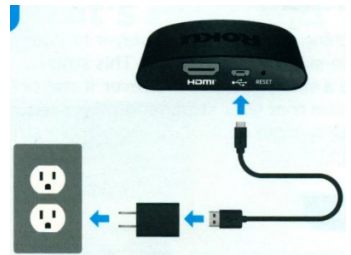

3. Position the **Roku Express Player** near your TV. Make sure that the front of the device has a direct line of sight with the **Roku remote**. Do not place the device behind your TV or inside a cabinet.





4. Turn on your TV and select your input via your TV remote (choose an HDMI input)

5. Connect to your home Wi-Fi network. If prompted, set your display type. Choose **Automatic** or your preferred type.



6. Go to home page on the Roku by selecting the home icon  on the **Roku remote**. Watch movies, TV shows, and more using the Hoopla, Kanopy, Roku, and Netflix apps.

7. Hoopla and Kanopy are streaming apps available with your Lake Forest Library card number. To create your accounts and begin streaming, visit lakeforestlibrary.org/stream.

8. Select the  icon on the **Roku remote** for more options and the arrow button  to go back a page. Use the ???  on the **Roku remote** to go back to the previous screen.

9. Before you return the **Roku Express Player**, log out of you Hoopla and Kanopy accounts. **Stay logged in to the Library's Netflix and Roku accounts.**

Roku Express Player

Cost to Replace: \$30

Stream movies and shows on your TV using the Library's Netflix and Roku accounts and your personal Hoopla and Kanopy accounts.

Parts List

- (1) This instruction booklet with envelope
- (1) Roku Express Streaming Player
- (1) Roku remote
- (1) HDMI cable
- (1) USB power cable
- (1) AC power adaptor

More Resources:

Roku website for video tutorials and wireless help
go.roku.com/express

Sign up for Kanopy and Hoopla accounts for free through Lake Forest Library with your library card
lakeforestlibrary.org/stream

Rental Info

Two week checkout with one autorenewal (if there are no holds on the item).

Overdue fine: \$2 per day

Item must be returned inside to the Adult Circulation Desk. **No book drop returns.**



www.lakeforestlibrary.org/tot